

dulwich  
DESIGNS

Your watch rotator instructions.

©Dulwich Designs. All rights reserved. All products are proprietary and/or patented by Dulwich Designs

### Watch Rotator Instructions

Your Watch Rotator comes with a mains powered international adapter, the socket is located at the back of the unit. Some models of watch rotator can also operate on battery power.

If you choose to operate your watch rotator by batteries, insert standard D-cell batteries (not included), into the battery housing found on the back of the case. Make sure to insert the batteries matching the "+" and "-" signs. You can expect approximately 6 months of battery life when the winder is in the continuous operation.

We recommend Alkaline batteries are used for improved battery life.

### Preparing Your Rotator

Remove the watch cuff by pulling firmly on the tabs of the cuff. Place your watch over the centre of the cuff (.1), with the face of the watch outward. To facilitate ease of closing your watch strap over the cuff, first compress the cuff & close the watch strap. Tighten the straps or bracelet of the watch snugly so that it is held in place on the cuff.

Slide cuff back inside the case with the watch facing outward until it clicks into place. (.2). You are now ready to turn on your watch rotator.

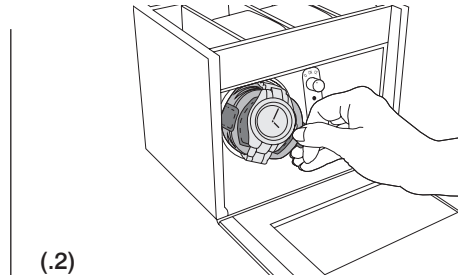
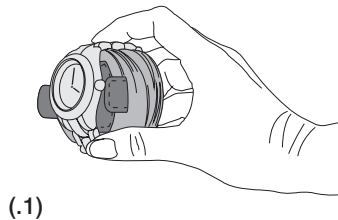

**Caution!** The Watch Rotator should never be turned manually as this may cause damage to your internal drive mechanism. Never remove your watch from the rotator while in operation.

#### **Control Panel:**

There are two rotary switches located on the control panel next to each rotator cuff.

Setting 0 - No Motion.

Setting ON – Rotator will begin motion within 10 seconds.

Setting 12 - Rotator will begin motion after 12 hours.

LED light - Green light will be displayed when in motion.

If a red light is displayed (when using battery only mode) please replace the batteries.

#### **Mode Switch**

**Mode A** – In this mode the winding drum will rotate in a clockwise direction for 155 revolutions (approx. 50 minutes) and then stop for approx. 190 minutes. This equals one 240 minute (4 hour) rotation cycle. This rotation cycle is repeated 4 times (16 hours). The rotator rests for 8 hours before it starts the same 24 hour cycle again.

**Mode B** – The operation of this mode is similar to that of Mode A except the rotation will be in the counter-clockwise direction.

**Mode C** – In this mode, the winding drum will start rotation in the clockwise direction for 155 revolutions and then rotate counter – clockwise for another 155 revolutions (approx. 100 minutes for both). It will then stop for approx. 140 minutes to complete one 4 hour cycle.

This is repeated 4 times before resting for 8 hours.

**Please Note;** Except in rare instances, all automatic watches will work in any of the above modes. The purpose for rotation is to wind the watch. The watch will wind regardless of the direction the rotation is moving. The rationale for multiple modes of rotation is to provide winding capabilities for even the most unique requirements for heirloom watches and/or those with specific complications

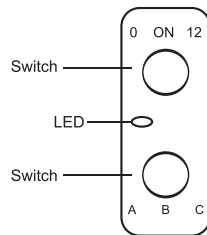

# dulwich

D E S I G N S

---

Premium automatic time pieces are more than just a means of telling the time, they are engineered masterpieces which should be treasured and stored correctly for future generations to also enjoy.

Dulwich Designs specialist programmed technology ensures watches are wound to the correct tension replicating human behavioural patterns for which the watch was originally designed.

Substantial on going investment in research and development ensures that Dulwich Designs Watch Rotators continue to lead the way by using the latest technology for the perfect winding of premium timepieces.

Thank you for purchasing this Dulwich Designs Watch Rotator, should you require any further assistance or advice then please do not hesitate to contact us as per the details below.

Help Line: 01622 714237  
Email: [enquiries@lc-designs.co.uk](mailto:enquiries@lc-designs.co.uk)  
Website: [www.lcdesigns.com](http://www.lcdesigns.com)

Address: LC Designs Co. Ltd,  
London House, Sheldon Way,  
Larkfield, Aylesford,  
Kent, ME20 6SE.