

PHILIPS

QP6520, QP6510

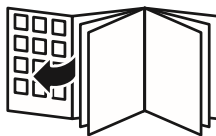

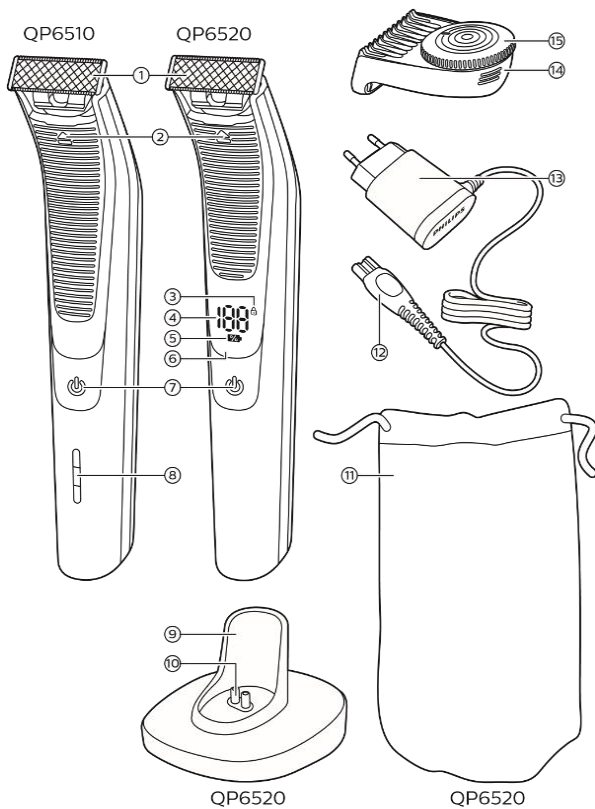



Introduction

Congratulations on your purchase and welcome to Philips! To fully benefit from the support that Philips offers, register your product at www.philips.com/welcome. **General**

description (Fig.1)

- | | |
|----|--|
| 1 | Blade |
| 2 | Blade release slide |
| 3 | Travel lock (QP6520 only) |
| 4 | Battery status percentage (QP6520 only) |
| 5 | Charge symbol (QP6520 only) |
| 6 | Display (QP6520 only) |
| 7 | On/off button |
| 8 | Battery status indicator (QP6510 only) |
| 9 | Charging stand (QP6520 only) |
| 10 | Small plug of the charging stand (QP6520 only) |
| 11 | Pouch (QP6520 only) |
| 12 | Small plug |
| 13 | Supply unit (adapter, type HQ8505) |
| 14 | Precision trimming comb 15 Hair length setting wheel |

Important safety information

Read this important information carefully before you use the appliance and its accessories and save it for future reference. The accessories supplied may vary for different products.

Danger



- Keep the supply unit dry.

Warning

- To charge the battery, only use the detachable supply unit (HQ8505) provided with the appliance.
- The supply unit contains a transformer. Do not cut off the supply unit to replace it with another plug, as this causes a hazardous situation.
- This appliance can be used by children aged from 8 years and above and persons with reduced physical, sensory or mental capabilities or lack of experience and knowledge if they have been given supervision or instruction concerning use of the appliance in a safe way and understand the hazards involved. Children shall not play with the appliance. Cleaning and user maintenance shall not be made by children without supervision.
- Always unplug the appliance before you clean it under the tap.
- Always check the appliance before you use it. Do not use the appliance if it is damaged, as this may cause injury. Always replace a damaged part with one of the original type.

- Do not open the appliance to replace the rechargeable battery.

Caution



- Never immerse the charging stand in water and do not rinse it under the tap.
- Do not use the supply unit in or near wall sockets that contain an electric air freshener to prevent irreparable damage to the supply unit.
- Only use this appliance for its intended purpose as shown in the user manual.
- For hygienic reasons, the appliance should only be used by one person.
- Never use water hotter than 60°C to rinse the appliance.
- Never use compressed air, scouring pads, abrasive cleaning agents or aggressive liquids such as petrol or acetone to clean the appliance.

Electromagnetic fields (EMF)

This Philips appliance complies with all applicable standards and regulations regarding exposure to electromagnetic fields.

General



- This appliance is waterproof. It is suitable for use in the bath or shower and for cleaning under the tap. For safety reasons, the appliance can therefore only be used without cord.

- The supply unit is suitable for mains voltages ranging from 100 to 240 volts.
- The supply unit transforms 100-240 volts to a safe low voltage of less than 24 volts.
- Maximum noise level: $L_c = 75 \text{ dB(A)}$.

Charging

Note: This appliance can only be used without cord.

QP6520, QP6510: Charging takes approx. 1 hour. A fully charged appliance has an operating time of up to 90 minutes (QP6520) or 60 minutes (QP6510).

Charge the appliance before you use it for the first time and when the charge symbol indicates that the battery is almost empty.

Battery status indicator QP6520

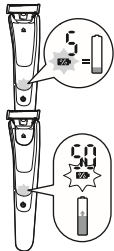

- When the charge symbol flashes orange, the battery is almost empty. The remaining battery capacity is indicated by the battery status percentage shown on the display.
- To indicate that the appliance is charging, the charge symbol flashes white.
- Quick charge: after approx. 5 minutes charging, the appliance contains enough energy for 5 minutes using. During quick charge the charge symbol flashes white quickly until quick charge is finished.
- The battery is fully charged when the battery status percentage shown on the display is 100% and the charge symbol lights up continuously.
- Approx. 30 minutes after the battery is fully charged or when you disconnect the appliance from the mains, the display switches off automatically.

Battery status indicator QP6510

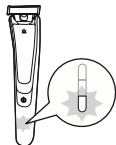

- When the battery status indicator flashes orange, the battery is almost empty.

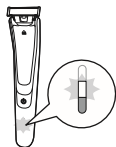

- To indicate that the appliance is charging, first the bottom light flashes white and then lights up white continuously. Then the second light flashes and then lights up continuously, and so on until the appliance is fully charged.
- Quick charge: after approx. 5 minutes charging, the appliance contains enough energy for 5 minutes using. During quick charge the lights of the battery status indicator will light up continuously one after another and then all switch off. This will repeat itself until quick charge is finished.
- The battery is fully charged when all lights of the battery status indicator light up continuously.
- Approx. 30 minutes after the battery is fully charged or when you disconnect the appliance from the mains, the lights of the battery status indicator switch off automatically.

Charging with the adapter

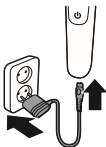

- 1 Insert the small plug into the appliance and put the supply unit in the wall socket.
- 2 After charging, remove the supply unit from the wall socket and pull the small plug out of the appliance.

Charging in the charging stand (QP6520 only)

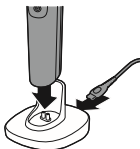

- 1 Insert the small plug into the charging stand and put the adapter in the wall socket.
- 2 Put the appliance in the charging stand.
- 3 After charging, remove the adapter from the wall socket and pull the small plug out of the charging stand.

Using the appliance



Note: This appliance can only be used without cord.

You can use the appliance to trim, edge or shave facial hair (beard, moustache and sideburns). Shave for a smooth result, trim to obtain a certain length and edge to create perfect edges and sharp lines. This appliance is not intended for shaving, edging or trimming hairs on lower body parts or scalp hair. Take your time when you first start to use the appliance. You have to acquire practice with the appliance.

Switching the appliance on and off

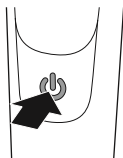

- 1 To switch on the appliance, press the on/off button once.
- 2 To switch off the appliance, press the on/off button once.

Before you use the appliance, always check the blade for damage or wear. If the blade is damaged or worn, do not use the appliance, as injury may occur. Replace a damaged blade before you use the appliance (see chapter 'Replacement').

Shaving tips and tricks

- Make sure that the blade is in full contact with the skin by placing it flat on the skin.
 - For the best result, move the appliance against the grain.
 - Make long strokes while pressing lightly.
 - You can use the appliance dry or wet with gel or foam. You can even use the appliance in the shower.
 - Shaving a clean beard and face gives the best results.
- 1 Switch on the appliance.



Note: Make sure you hold the surface of the blade flat against your skin.

- 2 Place the blade on the skin and move the appliance up or against the grain in long strokes while you press it lightly.



- 3** Switch off and clean the appliance after every use (see 'Cleaning and maintenance').

Edging

You can also use both edges of the blade to create sharp lines and perfect edges. Hold the appliance in such a way that the blade is perpendicular to the skin and one of its edges touches the skin. This allows more precise detailing of sideburns and the area around the mouth and nose.



- 1** To create sharp edges and lines, you can use either edge of the blade. **2** Switch on the appliance.

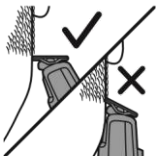

- 3** Place the edge of the blade perpendicular onto the skin.

- Make straight strokes while applying gentle pressure.
- 4** Switch off and clean the appliance after every use (see 'Cleaning and maintenance').



Trimming with comb

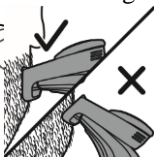

Tips

- Always trim in the direction of the teeth of the precision trimming comb making sure the flat part of the comb is in full contact with the skin for an even trimming result.
- Since hair grows in different directions, you need to hold the appliance in different positions as well. However, always make sure that you move the appliance upwards against the grain.
- Trimming is easier when the skin and hair are dry.

The precision trimming comb allows you to trim hair to different lengths. Start at the highest setting to acquire practice with this appliance. The settings on the wheel correspond to the hair lengths in millimeters.

- 1 Place the front part of the comb onto the blade and push the projection at the back of the comb into the appliance ('click').

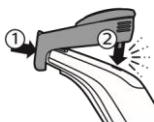

- 2 Turn the hair length setting wheel to select the desired hair length setting.



The settings on the wheel correspond to the hair lengths in millimeters.

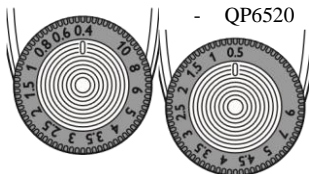

- QP6520

- QP6510

- 3 Switch on the appliance.

- 4 Place the comb onto the skin and move the appliance upwards slowly, against the grain.

- 5 Switch off and clean the appliance after every use (see 'Cleaning and maintenance').



- 6 To remove the comb, pull its back part off the appliance and then slide it off the blade.



Cleaning and maintenance

Clean the appliance after every use.

Caution: Never use compressed air, scouring pads, abrasive cleaning agents or aggressive liquids such as petrol or acetone to clean the appliance.



Caution: Do not tap the appliance against a surface to remove water from it, as this may cause damage. Replace the blade if it is damaged.

Cleaning the appliance

Caution: Do not dry the blade with a towel or a tissue as this may cause damage.



- 1 Remove the comb from the blade. Always turn the appliance off before putting on or taking off the comb.



- 2 If a lot of hairs have accumulated on the comb, first blow them off.



- 3 If a lot of hairs have accumulated on the appliance, first blow them off.



- 4 Then switch on the appliance and rinse the blade with lukewarm water.



- 5 Then rinse the comb with lukewarm water.

- 6 Let the appliance and comb dry.

Storage

Note: We advise you to let the appliance and its attachments dry before you store them for the next use.

Note: The blade is fragile. Handle it carefully. Replace the blade if it is damaged.

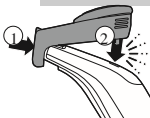

- 1 Always attach the precision trimming comb on the blade to protect the blade from damage during travelling or storage.

Travel lock (QP6520 only)

You can lock the appliance when you are going to travel. The travel lock prevents the appliance from being switched on by accident.

Activating the travel lock

- 1 Press the on/off button for 3 seconds.

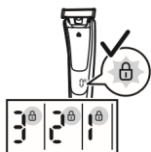
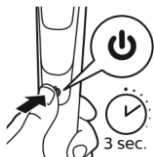

- While you activate the travel lock, the travel lock symbol lights up and the digital display counts down.
- When the travel lock is activated, the travel lock symbol flashes.

Deactivating the travel lock

- 1 Press the on/off button for 3 seconds.

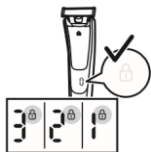

- While you deactivate the travel lock, the display counts down. Then the travel lock symbol lights up and switches off.
- The appliance is now ready for use again.

Replacement

Usage indicator

For optimal cutting and gliding performance, we advise you to replace the blade every 4 months, when it no longer provides the shaving or trimming results you expect or when the usage indicator appears.

The blade is equipped with a usage indicator which gradually turns green. When the green bar is highly visible, it is recommended to replace your blade. Always replace the blade with an original Philips blade.

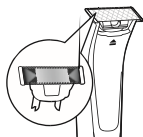

Depending on your usage behavior, the exact lifetime of the blade could be longer or shorter. Similar to a manual blade, the blade becomes blunt over time, which results in increased hair pulling and reduced cutting performance. **Replacing the blade**

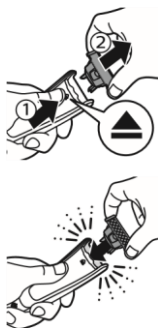

- 1 Push the blade release slide upwards carefully, and hold the blade on both sides to remove the blade. This will prevent the blade from flying off the handle.
- 2 Hold the new blade on its sides and press it onto the handle ('click').

Note: When you hear a click, the new blade is placed correctly and ready for use.

Ordering accessories

To buy accessories or spare parts, visit www.shop.philips.com/service or go to your Philips dealer. You can also contact the Philips Consumer Care Center in your country (see the international warranty leaflet for contact details).

The following parts are available:

- QP210 Blade 1-pack

- QP220 Blade 2-pack

Recycling

- This symbol means that this product shall not be disposed of with normal household waste (2012/19/EU).
- This symbol means that this product contains a built-in rechargeable battery which shall not be disposed of with normal household waste (2006/66/EC). Please take your product to an official collection point or a Philips service center to have a professional remove the rechargeable battery.
- Follow your country's rules for the separate collection of electrical and electronic products and rechargeable batteries. Correct disposal helps prevent negative consequences for the environment and human health.



Removing the rechargeable battery

Caution: Only remove the rechargeable battery when you discard the appliance. Make sure the battery is completely empty when you remove it.

Note: We strongly advise you to have a professional remove the rechargeable battery.

- 1 Disconnect the appliance from the mains and let the appliance run until the motor stops.
- 2 Remove the blade from the appliance.

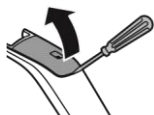

- 3 Insert a screwdriver under the back panel and remove the panel.

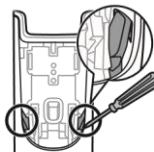

- 4 Break the snap connections on both sides with the screwdriver.

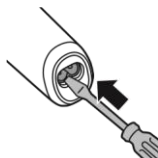

- 5 Push out the inner body by pushing the screwdriver into the bottom of the handle. - Now you see the printed circuit board.

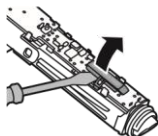

- 6 QP6510: remove the cover of the printed circuit board with the screwdriver.

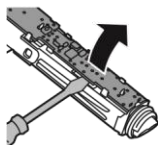

- 7 Remove the printed circuit board from the inner body with the screwdriver.

- 8 Lift the battery out of the inner body with the screwdriver. The battery is connected with double-sided tape.

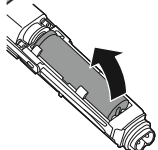

Warning: Be careful, the battery strips are very sharp.

Warranty and support

If you need information or support, please visit www.philips.com/support or read the international warranty leaflet.

Guarantee restrictions

The blade is not covered by the terms of the international guarantee because it is subject to wear.

Troubleshooting

This chapter summarizes the most common problems you could encounter with the appliance. If you are unable to solve the problem with the information below, visit **www.philips.com/support** for a list of frequently asked questions or contact the Consumer Care Center in your country.

| Problem | Possible cause | Solution |
|--|--|--|
| I cannot switch the appliance when it is charging. You can only use the mains. | You cannot use the appliance when it is connected to the mains. You can only use the appliance without cord. | Disconnect the appliance on the mains before use. |
| Problem | Possible cause | Solution |
| The appliance does not work anymore. | The rechargeable battery is empty. | Charge the appliance (see chapter 'Charging'). During charging, the battery charge indicator flashes white. If the battery charge indicator does not flash, check whether there is a power failure or if the wall socket is live. If there is no power failure and the wall socket is live but the battery charge indicator still does not flash, take the appliance to your dealer or a Philips service center. |

| | The blade is blocked by dirt. | Switch on the appliance and rinse the blade under the tap with warm water. |
|--|--|---|
| | | Hold the blade in a cup with warm water (60°C and not hotter) for approx. 30 seconds. |
| | Travel lock is activated. | Press the on/off button for 3 seconds to deactivate travel lock. While you deactivate the travel lock, the display counts down. Then the travel lock symbol lights up and switches off. The appliance is now ready for use again. |
| The appliance does not cut hairs anymore. | The blade is placed on the handle incorrectly. | Push the blade onto the appliance until you hear a click. |
| | The blade is damaged or worn. | Replace the blade with a new one. See chapter 'Replacement'. |
| Problem | Possible cause | Solution |
| The appliance makes a strange noise. | The blade is damaged or worn. | Replace the blade with a new one. See chapter 'Replacement'. |
| | The blade is placed on the handle incorrectly. | Remove and reattach the blade. Push it onto the appliance until you hear a click. |
| | The blade is blocked by dirt. | Remove the blade and clean the blade thoroughly. |
| The appliance does not function optimally anymore. | The blade is blocked by dirt. | Remove the blade and clean the blade thoroughly. |

The blade is subject to wear and therefore its performance decreases over time.

Replace the blade with a new one. See chapter 'Replacement'.

The blade is a delicate part of the appliance and can easily be damaged. If the blade is damaged, it may not function optimally anymore.

Replace the blade with a new one. See chapter 'Replacement'.