

**AirCraft®**

**LUME® MINI**

AIR CIRCULATOR



Thank you for purchasing this **LUME MINI** Air Circulator.



For the German, French, Spanish or Italian version of this Instruction Manual,  
please visit: **[AirCraft-Home.com/LUME-manual](http://AirCraft-Home.com/LUME-manual)**

## SAFETY INSTRUCTIONS & WARNINGS

Before using this appliance, please read all instructions and cautionary markings in this User Guide, and on the appliance. These apply to the appliance and also to all accessories and mains adaptors. To reduce the risk of fire, electric shock, or injury, please carefully read the following:

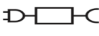
1. Improper use of this appliance may pose safety hazards and cause injury. Exercise caution during operation. Do not leave the appliance unattended while it is running.
2. This appliance can be used by children aged from 8 years and above and persons with reduced physical, sensory or reasoning capabilities, or lack of experience and knowledge, only if they have been given supervision or instruction by a responsible person concerning use of the appliance in a safe way and understand the hazards involved.
3. Children should not play with this appliance.
4. Cleaning and user maintenance shall not be made by children without supervision. Close attention is necessary when used by or near children.
5. The appliance is only to be used with the Power Supply unit provided with the appliance (model DZ024EHL240100V).
6. The appliance must only be supplied at safety extra low voltage corresponding to the marking on the appliance.
7.  Detachable Power Supply unit
8. Do not cover the fan during operation, and ensure it is placed on a flat, stable surface. Avoid tipping it over in use, as this can result in damage and create a potential hazard.
9. Do not immerse the appliance, power cable or plug in water or other liquid. Avoid using near bathtubs, showers, washbasins, or vessels containing water. Do not operate in pooled or standing water, and do not allow any part of the electrical components to become wet, as this may create risk of injury from electric shock. Do not use if any part becomes wet.

10. Avoid touching moving parts, and never insert fingers, body parts, or objects through the fan grille, to prevent injury.
11. This appliance is designed for domestic use only. Do not store or use outdoors.
12. Before connecting this appliance to a wall socket, verify that the local power supply matches the specifications indicated on the appliance's rating plate/power adaptor. Always plug the appliance into an earthed socket for safety. Use the appliance only with the provided power adaptor, to avoid malfunction and risk of a fire hazard.
13. Unplug from the electrical supply before performing cleaning or maintenance tasks. Avoid removing fan guards for cleaning or maintenance to prevent accidents.
14. Periodically inspect the power adaptor for signs of damage. The cable attached to the power adaptor cannot be replaced. If the cable becomes damaged, the power adaptor must not be used and must be discarded. Please contact AirCraft for a replacement: [Support@aircraftvacuums.com](mailto:Support@aircraftvacuums.com).
15. If any the pins of the power adaptor plug are damaged, the adaptor should not be used, and should be discarded to prevent the risk of electrical shock or a fire hazard.
16. Assemble the fan completely before turning it on. Refer to the corresponding section in this manual for instructions on assembly.
17. Do not block air intakes to prevent overheating, as this may present a risk of fire or electrical hazard. Do not use near curtains, walls, or anything that will restrict airflow to the appliance.
18. During operation, avoid placing the appliance near inflammable or explosive objects.
19. Keep plastic bags properly stored and away from children to avoid danger of suffocation.

**AirCraft®**

# LUME® MINI

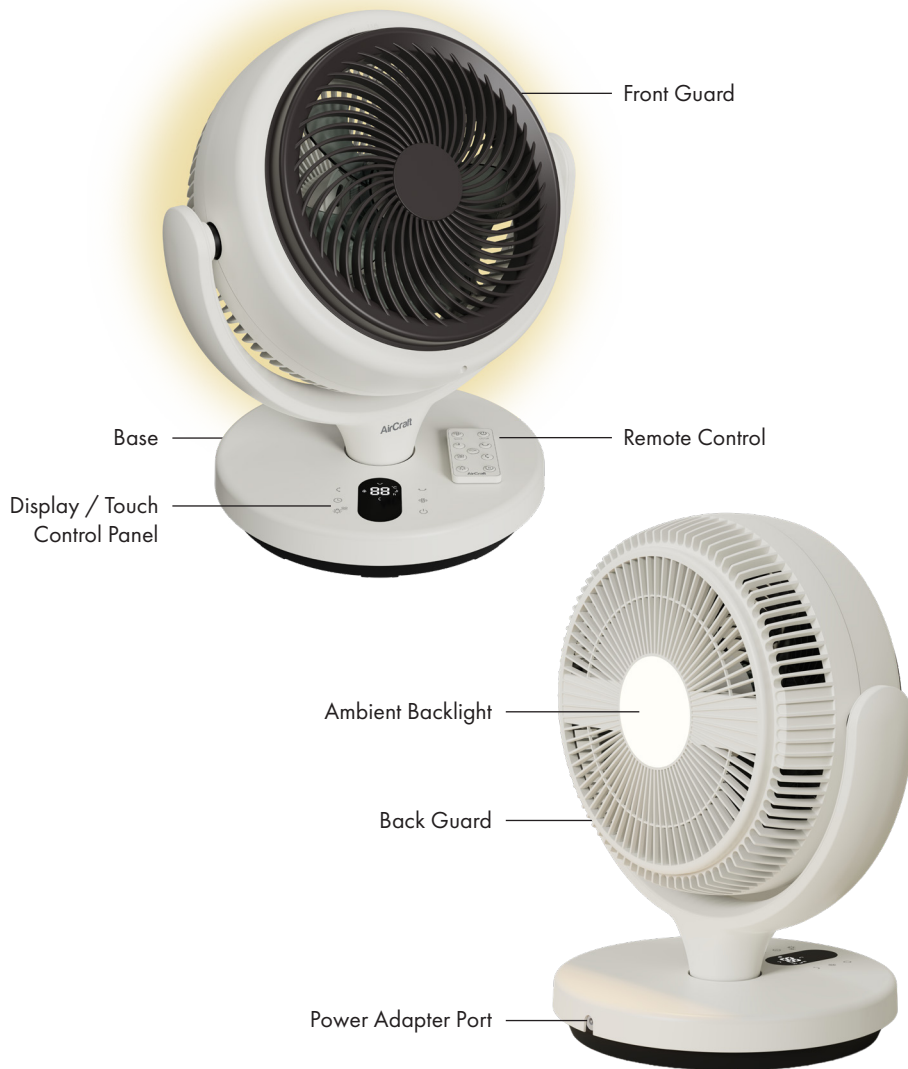

## TOUCH CONTROL PANEL & REMOTE CONTROL

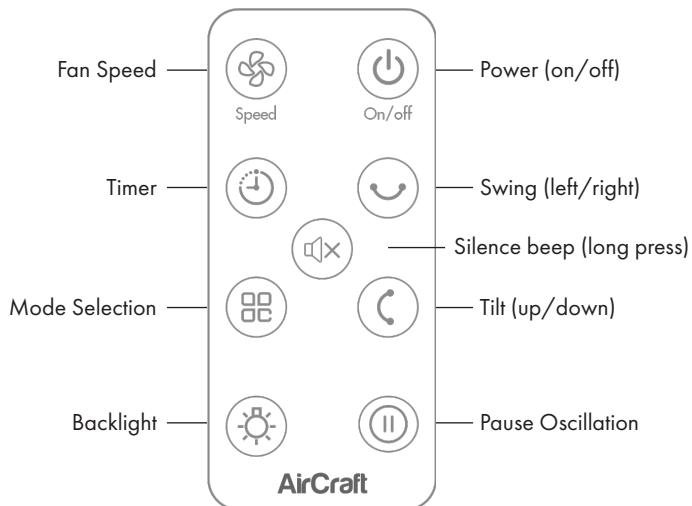
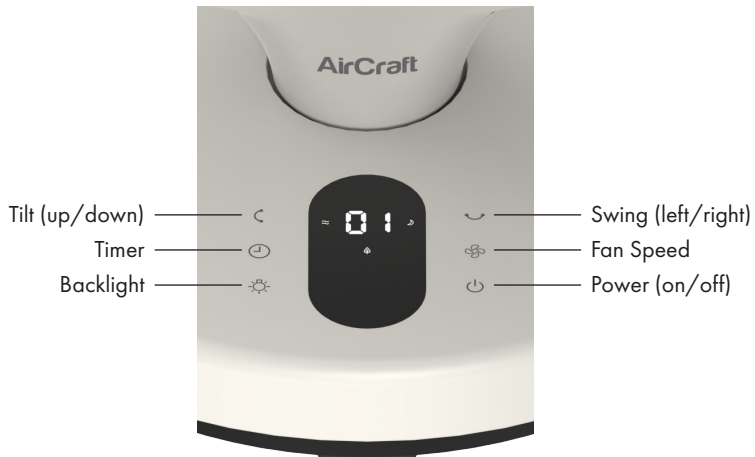

## CONNECTING TO POWER SUPPLY

1. Connect the **Power Adapter** cable to the **Power Adapter Port** on the rear of the **Base**.  
**Important: only use the Power Adaptor supplied.**
2. Insert the plug into a power socket.

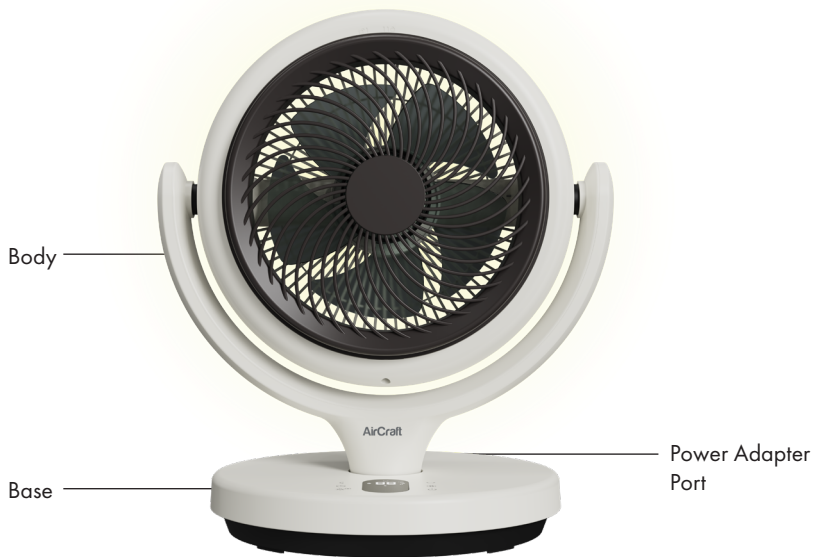

## BEFORE USE

- Make sure that the product is placed on a flat and stable surface.
- Ensure that the power socket is close to your **LUME MINI** and easily accessible.
- Always position the power cord so nobody can trip over it.

## REPLACING THE REMOTE CONTROL BATTERY

The Remote Control is powered by a **CR2025** button cell.

1. Locate the battery compartment door on the back of the Remote Control.
2. Pinch the tab (A) and simultaneously pull the battery tray out (as shown in the figure below).
3. Place a new **CR2025** battery in the battery tray, with the correct polarity as indicated.
4. Close the battery tray.

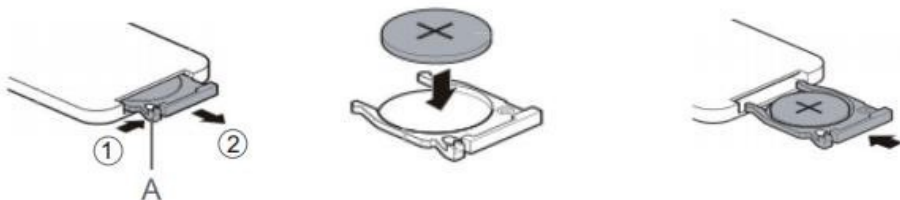

## GETTING STARTED

- Connect the supplied **Power Adaptor** cable to the **Power Adapter Port** and then connect the plug to a power socket.
- To turn your **LUME MINI** on or off, press the **Power** button on the Control Panel or the Remote Control.
- On start-up, **LUME MINI**'s initial default speed setting is 3. The **LED Display** shows the current setting.
- The **LED Display** will automatically turn off after one minute, to avoid light disturbance if being used whilst sleeping in a dark room. Simply press any button on the Control Panel or Remote Control to turn the LED Display back on.

## SETTING THE FAN SPEED

- When **LUME MINI** is on, press the **Fan Speed** button on the Control Panel or Remote Control to select the desired speed level (there are 12 speed levels).
- The current speed level will be visible on the **LED Display**.
- When the **Fan Speed** button is held down, the speed level will increase in multiples of 3.

## SETTING THE TIMER

- Press the **Timer** button once on the Control Panel or on the Remote Control.
- If there is no timer set, the **LED Display** indicates '0H' (0 hours).
- To set a sleep timer for between 1 - 12 hours, press the **Timer** button repeatedly until you reach your desired time. The fan will stop once the selected time has expired.

## SETTING FAN OSCILLATION

- You can set the fan to oscillate whilst the fan is operating, to distribute cool air faster and more efficiently around the room.
- To select horizontal rotation, press the **Swing (left/right)** button on the Control Panel or the Remote Control.
- To activate or deactivate vertical rotation, press the **Tilt (up/down)** button on the Control Panel or on the Remote Control.
- There are 3 angle settings (30°/60°/90°); press the button repeatedly until you reach your desired setting.
- Selecting both horizontal and vertical rotation will activate **Air Circulator (3D)** mode.
- Pressing **Pause** on the remote control will stop rotation until the **Pause** button is pressed again.

## MODE SELECTION (Remote Control only)

- **LUME MINI** features 3 modes: Normal (default setting when first turned on); Natural; and Sleep.
- To switch modes, press the **Mode Selection** button. With each press of this button, **LUME MINI** will cycle from 'Normal' to 'Natural' to 'Sleep', and back to 'Normal'.
- **NORMAL Mode:** The fan will remain at a constant speed, unless changed manually.
- **NATURAL Mode:** The fan will run at alternating speeds, to simulate an outside breeze with occasional gusts and lows.
  - When you enter **Natural Mode** the **LED Display** will first show 'CF'.
  - Press the **Speed** button to set the average fan speed you desire.
- **SLEEP Mode:** The fan will reduce speed every 30 minutes, until it reaches level 1 where it will remain.
  - The **LED Display** first shows 'SL' when you enter **Sleep Mode**.
  - Press the **Speed** button to set the starting fan speed you desire.



## LUME BACKLIGHT

- **LUME MINI**'s ambient Backlight has 3 brightness settings.
- Press the **Backlight** button on the Control Panel or Remote Control:
  - This will turn the Backlight on (at 100% brightness level)
  - Press again to reduce the brightness to 70%, and again to reduce to 50%
  - Press a fourth time to turn the Backlight off

**LUME MINI**'s Backlight can be used regardless of whether the fan is operating.

## "BUTTON-PRESS" TONE

- **LUME MINI** emits a gentle beeping sound to confirm that a button on the Control Panel or Remote Control has been pressed. This may be turned off/on as follows:
- Long press the **Backlight** button on the Control Panel; or
- Long press the **Silence** button on the Remote Control.
- Turning the fan on/off will reset this feature.

## MAINTENANCE & CLEANING

- Switch **LUME MINI** off and unplug from the mains socket before cleaning.
- Allow **LUME MINI** to cool before attempting to maintain or clean it.
- Do not remove the fan guards for cleaning or maintenance.
- Do not allow water or any other liquid to enter the motor section as it can cause short circuits, fires, electric shocks or other hazards.
- Do not use any abrasive cleaning liquids, rubbing alcohol or other chemical solutions as they can cause damage to the housing and result in malfunction.
- Keep air vents at the rear of **LUME MINI** free from dust and lint.
- You may use a vacuum cleaner to remove dust and lint from the air vents and fan guards.
- Clean **LUME MINI**'s exterior with a soft cloth.
- Store **LUME MINI** in a cool, dry place if not used for an extended period.

## TECHNICAL SPECIFICATIONS

Description	Symbol	Value	Unit
Maximum fan flow	F	13.69	m <sup>3</sup> /min
Fan power input	P	20.5	W
Service Value	SV	0.668	(m <sup>3</sup> /min)/W
Standby power consumption	PSB	0.38	W
Fan sound power level	LWA	60.2	dB(A)
Maximum air velocity	c	4.13	Meters/sec
Seasonal electricity consumption	Q	6.99	kWh/a
Measurement standard for service value	EN IEC 60879:2019 – Comfort fans and regulators for household and similar purposes – Methods for measuring performance		

## SPECIFICATIONS

Model	LUME MINI
SKU	LUMEDESK-W
Product Size	W365 x D280 x H415mm
Net Weight	2.1kg
Rated Frequency	--
Rated Voltage	24,0 V DC
Rated Power	24W

## POWER ADAPTOR SPECIFICATIONS

Model No	DZ024EHL240100V
Input	100-240V~ 50/60Hz, 0.8A
Output	24.0V DC 1.0A 24.0W
Type	Detachable supply unit
Adaptor Manufacturer	Keerda Electronics Co Ltd, Foshan City, Guangdong, P.R.C.

## GUARANTEE

We hope that you are delighted with this AirCraft product. We aim to provide the very best standard of customer care.

We support this product with a 12-month guarantee from the date of purchase. Guarantees are valid only if the product has been properly maintained and is used for domestic purposes only, in line with this User Guide, and has received only manufacturer-authorised repairs, servicing or alterations. It excludes defects arising from accidental damage, misuse and fair wear and tear.

Please see [AirCraft-Home.com](http://AirCraft-Home.com) for full terms and conditions of our guarantee.

Under-guarantee products that meet these conditions and that function improperly will be serviced or replaced at our sole discretion. It is your responsibility to securely package items for their safe return to us using a trackable service. Not doing so will void your guarantee.

We may be contacted at [Support@AirCraftVacuums.com](mailto:Support@AirCraftVacuums.com), or **+44 (0) 121 582 2641**.

AirCraft disclaims any liability for incidental or consequential damages. Your statutory rights are not affected.

## ENVIRONMENTAL PROTECTION CORRECT DISPOSAL (WASTE, ELECTRICAL & ELECTRONIC EQUIPMENT)



This symbol means that according to local laws and regulations your product shall be disposed of separately from general household waste. When this product reaches its end of life, contact your supplier or take it to a collection point designated by local authorities. The separate collection and recycling of your product at the time of disposal will help conserve natural resources and ensure that it is recycled in a manner that protects human health and the environment.



**AirCraft<sup>®</sup>**

**AirCraft-Home.com**

support@aircraftvacuums.com

+44 (0)121 5822 641

© 2026 AirCraft Home Ltd. All rights reserved.