



**#1 CHOICE**  
FOR TRADE PROFESSIONALS

# 5 in 1 Combination Ladder

## Instruction Manual



## BEFORE USE

- Read all instructions on and accompanying the ladder.



- Inspect the ladder after delivery. Before every use visually check the ladder is not damaged and is safe to use.

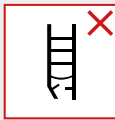

- Do not use a damaged ladder.

- Do not use the ladder if you are not fit enough. Certain medical conditions or medication, alcohol or drug abuse could make ladder use unsafe.



- Ensure the ladder is suitable for the task.



- Visually check the ladder is not damaged and is safe to use at the start of each day when the ladder is to be used.

- Inspect ladder feet.



- Do not use the ladder until the stabiliser bar has firstly been fully attached and secured to the ladder.

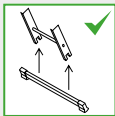

- Do not use the ladder if contaminated, e.g. with wet paint, mud, oil, water or snow.

- Prevent damage of the ladder when transporting e.g. by fastening and ensure they are suitably placed to prevent damage.

- For professional users regular periodic inspection is required.

- For professional use, a risk assessment shall be carried out respecting the legislation in the country of use.

- Do not modify the ladder design.

## POSITIONING & ERECTING THE LADDER

- When positioning the ladder, take into account risk of collision with the ladder e.g. from pedestrians, vehicles or doors. Secure doors (not fire exits) and windows where possible in the work area.

### • Warning! Electricity hazard.

Identify any electrical risks in the work area, such as overhead lines or other exposed electrical equipment and do not use the ladder where electrical risks occur.



- Do not erect ladder on contaminated ground. Ladders shall not be positioned on slippery surfaces (such as ice, shiny surfaces or significantly contaminated solid surfaces) unless additional effective measures are taken to prevent the ladder slipping or ensuring contaminated surfaces are sufficiently clean.

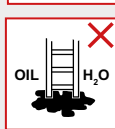
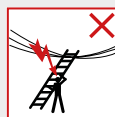

- Do not use the ladder on an unlevel or unfirm base.



- Ladder shall be on an even, level and unmovable base.

- Do not lean the ladder against unsuitable surfaces. Leaning ladder should lean against a flat non-fragile surface and should be secured before use e.g. tied or use of a suitable stability device.



- Standing ladders shall not be used as a leaning ladder unless it is designed to do so.



- Ladder shall be erected at the correct position with the rungs or treads level and complete opening of a standing ladder.

- Open the ladder fully before use.



- Use the ladder with restraint devices engaged only.



- Only use the ladder in the direction as indicated.

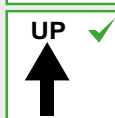

- Ladder shall be erected at the correct position, such as the correct angle for a leaning ladder (angle of inclination approximately 1:4) with the rungs or treads level.



- Keep the arrow vertical for correct working angle.

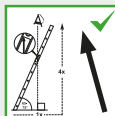

- Locking devices shall be checked and be fully secured before use.



- Ladder should be stood on its feet, not the rungs or steps.

- Leaning ladders with steps, shall be used that the steps are in a horizontal position.

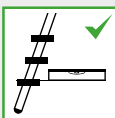

- Secure ladder at the top and bottom wherever possible. If not, station someone at the foot of the ladder.
- Do not move a ladder while standing on it.
- Ladder shall never be repositioned from above.

## USING THE LADDER

- Do not exceed the maximum total load (load includes users, tools, materials, etc.).



- Maximum number of users on the ladder.

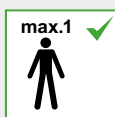

- Do not wear unsuitable footwear when climbing a ladder.

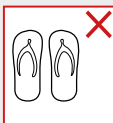

- Do not ascend or descend unless you are facing the ladder.



- Keep a secure grip on the ladder when ascending and descending. Maintain 3 points of contact whilst working from a ladder or take additional safety precautions if you cannot.



- Do not stand on the top three steps / rungs of a leaning ladder.



- Do not stand on the top two steps / rungs of a standing ladder without a platform and a hand / knee rail.



- When used in the standing ladder position with extending ladder at the top or in the stairway position, do not stand on the top four steps / rungs.



- Do not climb above the top four steps / rungs when in extended free-standing mode.

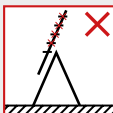

- Do not climb above the top four steps / rungs when in stairway mode.

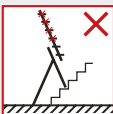

- Do not stand on these rungs / steps or the tool tray (if applicable).



- Do not overreach, user should keep their belt buckle (navel) inside the stiles and both feet on the same step / rung throughout the task.



- Avoid work that imposes a sideways load on ladders, such as side-on drilling through solid materials.



- Do not carry equipment which is heavy or difficult to handle whilst using a ladder.



- Equipment carried while using a ladder should be light and easy to handle.

- Leaning ladders used for access to a higher level shall be extended at least 1m above the landing point and secured if necessary.



- Do not step off the side of standing or leaning ladder onto another surface.



- Use non-conductive ladders for unavoidable electrical work.

- Secure doors (not fire exits) and windows where possible in the work area.

- Do not use the ladder outside in adverse weather conditions, such as strong wind.

- When outdoors, be cautious in windy conditions.

- Ladders should only be used for light work of a short duration.

- Do not spend long periods on the ladder without regular breaks (tiredness is a risk).

- Do not use the ladder as a bridge.

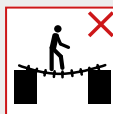

- Take precautions against children playing on the ladder.

## REPAIR, MAINTENANCE & STORAGE

- Repairs and maintenance shall be carried out by a competent person and be in accordance with the producer's instructions.

- Ladders should be stored in accordance with the producer's instructions.

- Replacement spare parts are available to order at [wernerco.com](http://wernerco.com).

## LIST OF ITEMS TO BE INSPECTED

For regular inspections, the following items shall be taken into account-

### Check:

- ☑ The stiles/legs (uprights) are not bent, bowed, twisted, dented, cracked, corroded or rotten.
- ☑ The stiles/legs around the fixing points for other components are in good condition.
- ☑ The fixings (usually rivets, screws or bolts) are not missing, loose or corroded.
- ☑ The rungs/steps are not missing, loose, excessively worn, corroded or damaged.
- ☑ The hinges between the front and rear sections are not damaged, loose or corroded.
- ☑ The locking stays horizontal, back rails and corner braces are not missing, bent, loose, corroded or damaged.
- ☑ The rung hooks are not missing, damaged, loose or corroded and engage properly on the rungs.
- ☑ The guide brackets are not missing, damaged, loose or corroded and engage properly on the mating stile.
- ☑ The ladder feet/end caps are not missing, loose, excessively worn, corroded or damaged.
- ☑ The entire ladder is free from contaminants (e.g. dirt, mud, paint, oil or grease).
- ☑ The locking catches (if fitted) are not damaged or corroded and function correctly.
- ☑ The platform (if fitted) has no missing parts or satisfied, you should NOT use the ladder.

If any of the above checks cannot be fully satisfied, you should NOT use the ladder.

## **STORAGE CHECKLIST**

The important considerations when storing a ladder (not in use) should include the following:

- ☑ Is the ladder stored away from areas where it's condition could deteriorate more rapidly e.g. dampness, excessive heat, or exposed to the elements?
- ☑ Is the ladder stored in a position which helps it remain straight e.g. hung by the stiles on proper ladderbrackets or laid on a flat clutter free surface?
- ☑ Is the ladder stored where it cannot be damaged by vehicles, heavy objects, or contaminants?
- ☑ Is the ladder stored where it cannot cause a trip hazard or an obstruction?
- ☑ Is the ladder stored securely where it cannot be easily used for criminal purposes?
- ☑ If the ladder is permanently positioned (e.g. on scaffolding), is it secured against unauthorised climbing (e.g. by children)?

# Extension Ladder Mode

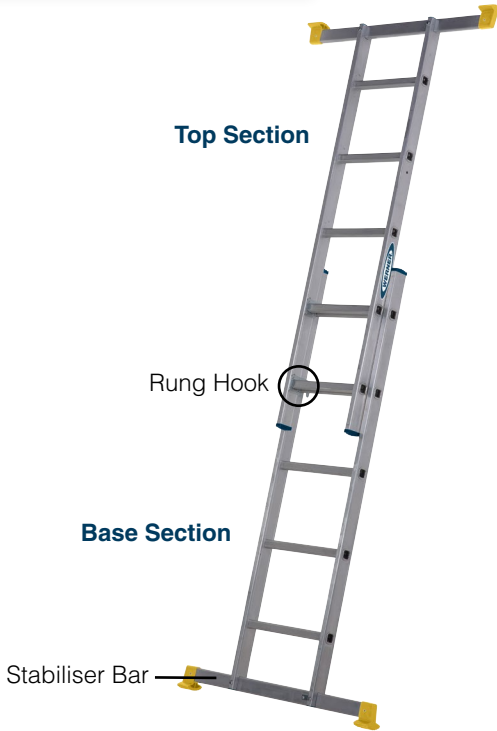

1. Release the rung hooks, lift the base section to disengage from the top section.

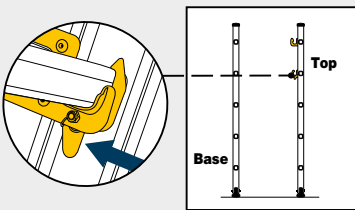

3. Ensure that the rung hooks are fully engaged and locked over the selected rungs.

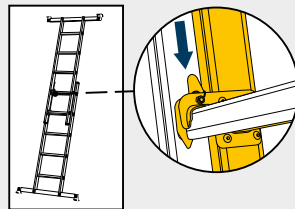

2. Lift and attach the top section to the base section. Ensure that the base section is located in the correct orientation as shown below.

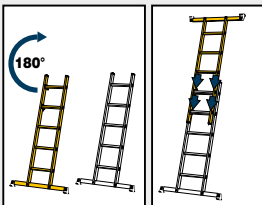

**Do not stand on the top three steps / rungs of a leaning ladder.**

# Stepladder Mode

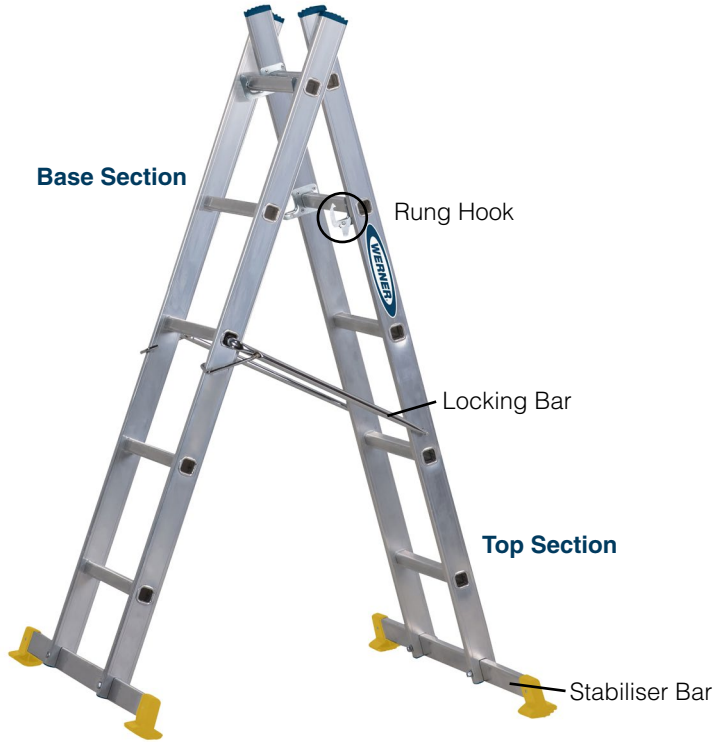

1. Release the rung hooks, lift the base section and open out the ladder.
2. Locate the rungs securely in the hooks.

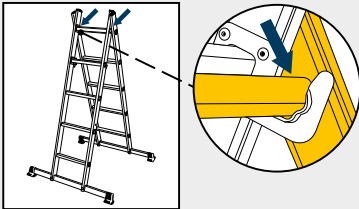

3. Locate and lock the locking bar ensuring the bar is secured in place.

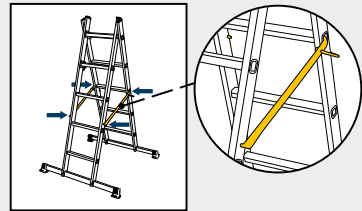

**Do not stand on the top two steps / rungs of a standing ladder without a platform and a hand / knee rail.**

# Stairwell Ladder Mode



1. Release the rung hooks, lift the base section and open out the ladder.
2. Locate the rungs securely in hooks.
3. Locate and lock the locking bar ensuring the bar is secured in place.

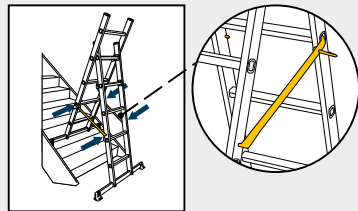
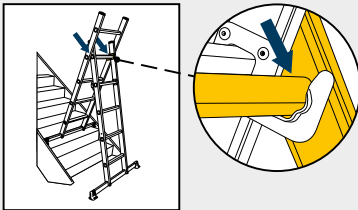

**When used in the standing ladder position in the stairwell mode, do not stand on the top four steps / rungs.**

# Platform Mode



1. Slot the ladder between the top and base section.
2. Ensure that the platform rung hooks are fully engaged and locked over the selected rungs.
3. Fit both restraint devices to secure the ladder and platform.

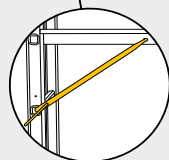
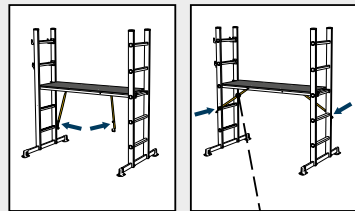
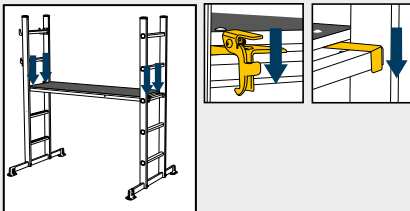

# Stairwell Platform Mode



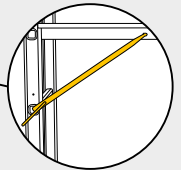
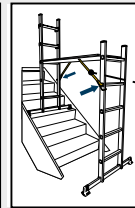
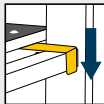
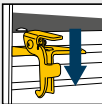
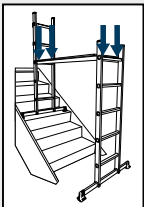

1. Slot the ladder between the top and base section, once placed at the designated height.
2. Ensure that the platform rung hooks are fully engaged and locked over the selected rungs.
3. Fit both restraint devices to secure the ladder and platform.





**Werner UK Sales & Distribution Ltd.**  
Blackwater Trading Estate, The Causeway,  
Maldon, Essex, CM9 4LJ

 [uk.customercare@wernerco.com](mailto:uk.customercare@wernerco.com)  
 [www.wernerco.co.uk](http://www.wernerco.co.uk)