



Planter Set

GREY (0302-SET1-G) FOREST (0302-SET1-F)



Customer Service: +44 (0) 1889 272 056

IMPORTANT: PLEASE REGISTER YOUR STONE GARDEN LIFESTYLE PRODUCT AFTER ASSEMBLY

Using the unique serial number found on the cover of this document, please visit
<https://bit.ly/StoneGardenWarranty> to register your product.

Affix Serial Number
HERE



Contents

1.	Parts List	3
2.	Overview	4
3.	Assembly Guidelines and Advice	5
4.	Planter Stacking Assembly	6
5.	Care Advice	7
6.	Limited Warranty	7

IMPORTANT: Keep this manual for future reference.

1. Parts List

Part Ref: 0302-04-02
Qty: x1

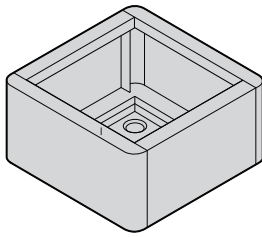

Part Ref: Divider 200H Kit
Qty: x1

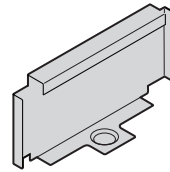

Part Ref: 0302-08-02
Qty: x1

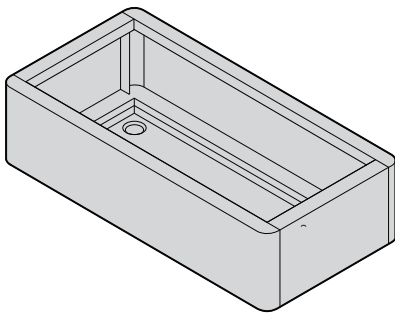

Part Ref: Divider 400H Kit
Qty: x1

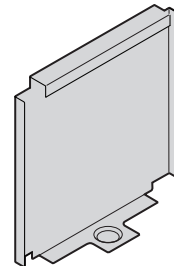

Part Ref: 0302-12-04
Qty: x1

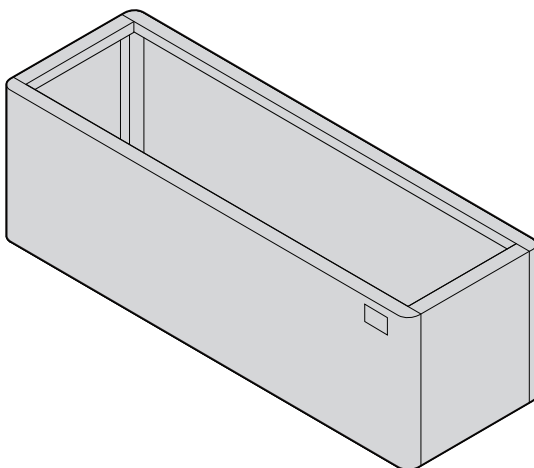

Part Ref: O259-CL
Qty: x3

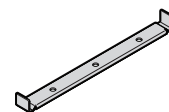

Part Ref: M6 x 10mm
Pan Head Torx Bolt
Qty: 6

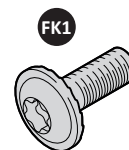

2. Overview

The perfect space to grow plants, herbs and blooms, The Stone planter is a stylish and versatile metal planter. Suitable for outdoor spaces, can be effortlessly stacked to create an individual and stunning outdoor display.

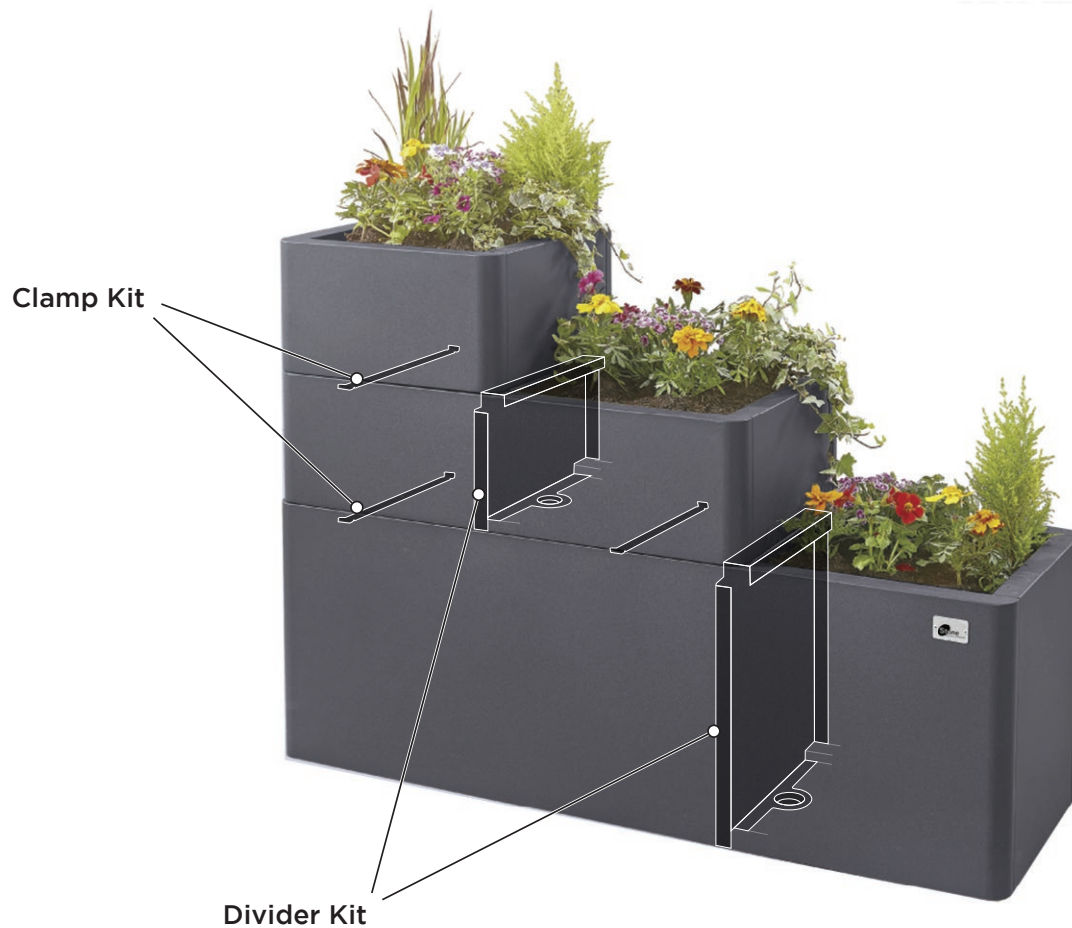

Further expanding the appeal of the Stone metal planter, waterproof and hard-wearing, these accessories are completely maintenance free and easy to attach, perfect for taking a break from gardening.

Designed to offer additional support, metal clamps are also available, bringing extra safety and stability to the planters in busy garden environments.



CAUTION:

Whilst every effort has been made in the manufacture of your appliance to remove any sharp edge, you should handle all components with care to avoid accidental injury.

3. Assembly Guidelines and Advice

Important Information

NOTE: the safe operational requirements, warnings & cautions. Use the product correctly and with care for the purpose for which it is intended. Failure to do so may cause damage and/or personal injury and will invalidate the warranty. Please keep these documents safe for future use.

Safety Instructions

Cautions and instructions in this manual cannot cover all possible situations and conditions that may occur. Common sense and caution are factors which cannot be built into these products.



Before beginning the assembly, check that you have the correct components. If for any reason you need assistance, please contact our customer service team on +44 (0) 1889 272 056.

Please read these instructions carefully before assembly and use.

- Make sure all plastic protection is removed before assembling.
- Attachment assembly should be carried out on an open, flat, level surface.
- Please refer to assembly diagram as necessary.
- To avoid losing any small component or hardware, assemble your product on a hard level surface that does not have cracks or openings.
- To prevent any possible damage to the flooring structure, ensure this product is correctly lifted, whilst moving from one position to another.
- Follow all steps in order to properly assemble your product.
- Wear correct safety gloves. Edges and corners can cause minor cuts if improperly handled during assembly.
- Do not force parts together as this can result in damage to the product.
- When applicable, tighten all components by hand first. Once all steps are completed, go back and fully tighten till firmly secure with the recommended hand-tool.

PERSONAL PROTECTION EQUIPMENT

We advise appropriate personal protective equipment is worn during assembly.



Gloves

4. Planter Stacking Assembly

M6 x 10mm
pan head torx
bolts. Qty: 6

Tool required: M6 Torx
T30 bit to remove and
secure bolts.



NOTE: Locate and position the M6 bolts through the base of upper planter, into the clamp 0259-CL, as Shown below.

⚠ Ensure clamp(s) are secured under the lip of the lower planter, before tightening the M6 bolts (FK1).

0302-04-02

200H Kit

Location Tab

0259-CL

0302-08-02

400H Kit

Location Tab

0259-CL

0302-04-02

⚠ **NOTE:** The dividers will need to be rotated into position, ensuring the location tab locks into place.

NOTE: Planter 0302-04-02 in length, will require 2 x clamps 0259-CL and 4 x M6 bolts (FK1).

4. Planter Stacking Assembly (Continued)

Stage One

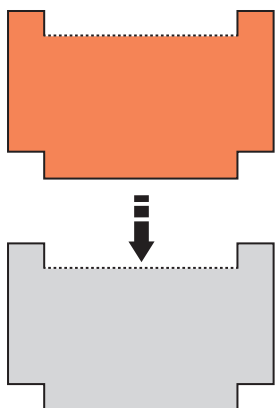

Locate and lower smaller planter into larger planter.

Stage Two

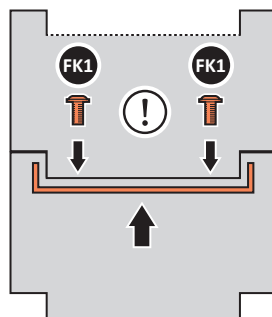

Locate clamp and secure both planters using M6 torx bolts (FK1).

Stage Three

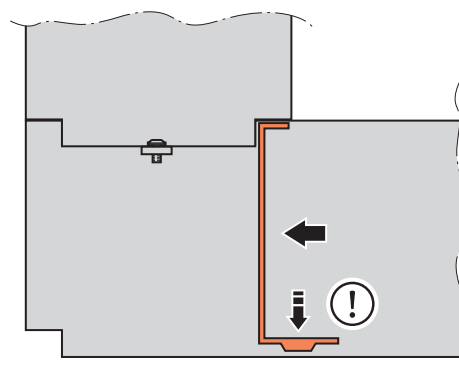

Locate divider and ensuring the location tab locks into place, as shown above.

5. Care Advice

Designed and built to stand the test of time, your new planter is low maintenance; requiring little more than a periodic clean to keep it looking its very best.

Here's some advice on how to look after it:

1. Regularly wipe down metal surface with detergent-free, warm soapy water and a non-abrasive sponge to clean.
2. Avoid using heavy detergents or power washers.
3. Perform maintenance checks at least once a year and ensure all fixings are secure.

6. Limited Warranty

Our Planter set comes with a 25 year warranty on all metal components, commencing from the date of purchase. The warranty includes manufacturing deficiencies and defective parts and extends to the replacement of these parts. Expenses for shipping, installation, replacement of worn parts and other cost are not covered by the warranty. The warranty lapses in case of mishandling and if any kind of unauthorised modifications are made to the appliance.



Customer Service: +44 (0) 1889 272 056