

# Technical Data Sheet

## Traditional 450mm Cloakroom Unit

What's in the box: 1x 545153 or 545154 Unit, Basin + Handle

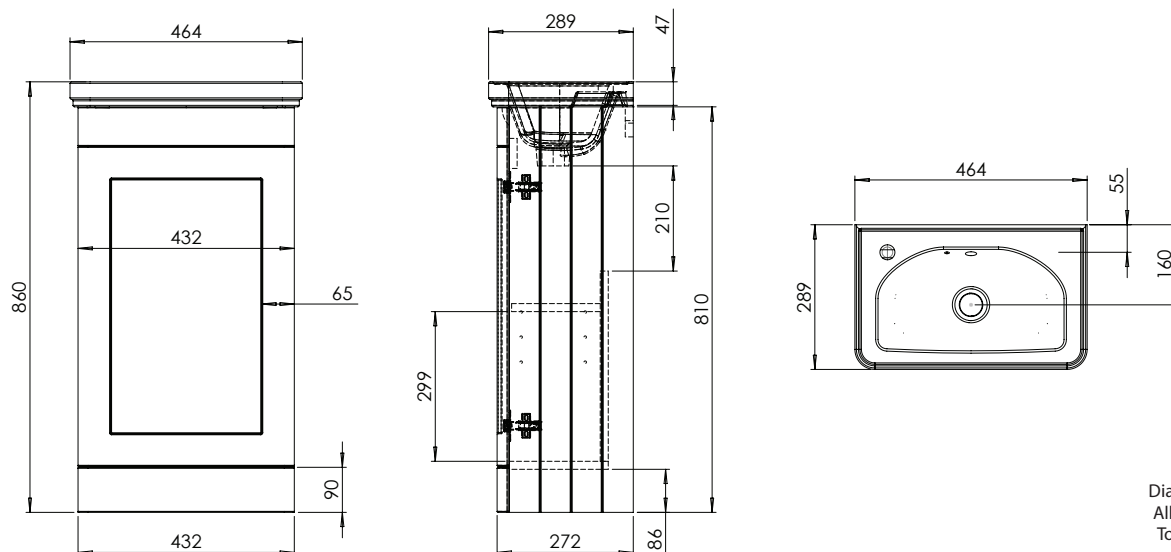

### Materials

Carcass: Painted MDF/MFC

Fascia Components: Painted MDF

\*\*Dimensions are subject to change, customers are advised to measure actual product before commencing installation.

\*\*\*Fixing point dimensions are for guidance only/the positions of wall fixing must be checked when product is received.

### FAQs

Q: How big is the plumbing void?

A: 50mm.

Q: Are the handles fitted?

A: No, pilot holes on the back face of the door are to be drilled by the installer.

Q: Are the hinges soft close?

A: Yes, the hinges are soft close

Q: Is the door reversible?

A: The door can be configured with hinges on the left or right hand side.

Q: How deep is the unit with door open?

A: Approximate depth with 90° hinge 680mm.

Q: Can the doors be adjusted?

A: The door can be adjusted as detailed in the supplied instructions.

Q: Is the shelf removable?

A: Yes, there is one removable shelf.

Q: What is the shelf capacity?

A: Shelf max. depth: 180mm.

Q: Is the shelf adjustable?

A: Yes, the shelf is adjustable.

Q: What is the interior finish of the unit?

A: Colour matched to external.

Q: How is the unit fixed to the wall?

A: You can secure the unit to the wall by drilling through the back brace using the pre-drilled holes.

NOTE: No RAL Code available