

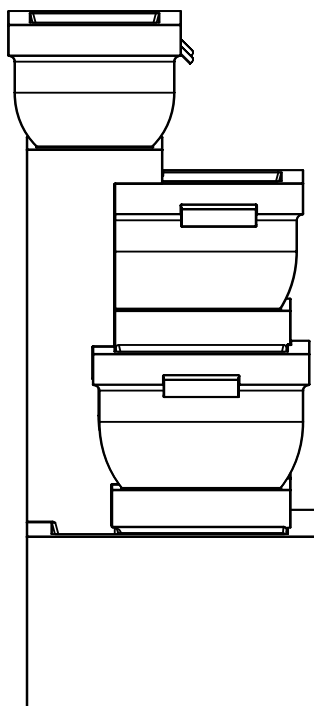

ASHBORO FOUNTAIN WITH COPPER SPOUTS

ITM./ART. 471014
MODEL #Y14043

**IMPORTANT, RETAIN FOR FUTURE
REFERENCE: READ CAREFULLY**



This item is intended for outdoor domestic use only. Not for commercial use.

ATTACH YOUR RECEIPT HERE



If you have any questions or concerns, please contact the manufacturer below:

Toll-free phone: 1-877-447-4768 | Monday - Friday, 9:00 am - 5:30 pm EST

All languages available by translation service.

Email: customerservice@ghpgroupinc.com Website: www.ghpgroupinc.com

Owner's Manual

SAFETY INFORMATION

ATTENTION: PLEASE ENSURE PUMP IS FULLY SUBMERGED UNDER WATERLINE PRIOR TO PLUGGING IT INTO GFCI OUTLET FOR USE.

WARNING

- Save these warnings and instructions for reference. Read all instructions before use.
- Failure to follow warnings and instructions may result in injury or property damage.
- Excessive weight or pressure on any of the fountain sections may cause it to fall. Keep pets, children, or anyone from sitting, leaning, or climbing on any of the fountain components.
- While fountain is designed to operate as splash free as possible, some water splashing out of the fountain is inevitable. Place the fountain in a location where any splashing will not cause damage.
- Always keep the fountain working with sufficient water and clean of debris and dirt to ensure proper functioning of the pump.
- If necessary, clean the fountain with a soft cloth and change the water frequently. Due to water evaporation, you may see a buildup of white residue on the fountain surface from mineral content in the water supply. To prevent such buildup, regularly clean the fountain with soap and water. Do not use any abrasive, which may damage the applied finish.
- Use of water clarifier or algaecide of any kind will damage the paint in the fountain and will not be covered under the manufacturer's warranty.
- This fountain is intended for outdoor use only.
- See the pump instructions for pump safety, maintenance, and warranty information.
- The pump on your fountain has no user-serviceable parts. Only an authorized service representative should service the pump.
- This appliance is not intended for use by persons (including children) with reduced physical, sensory or mental capabilities, or lack of experience and knowledge, unless they have been given supervision or instruction concerning use of the appliance by a person responsible for their safety.
- Children should be supervised to ensure that they do not play with the appliance.
- The appliance is only to be used with the power supply unit provided with the appliance.
- The water pump must only be supplied at safety extra-low voltage corresponding to the marking on the appliance.
- The supply cord cannot be replaced. If the cord is damaged, the transformer should be scrapped.
- The pump is to be supplied through a residual current device (RCD) having a rated residual operating current not exceeding 30 mA.

SAFETY INFORMATION

CAUTION

1. Install the fountain pump correctly before operating it.
2. Although the pump is equipped with a safety shut-off device, to avoid damage it is recommended not to let it run dry.
3. For fountains with multiple sections or attached decorations: If any of the fountain's attached sections with electrical lights or components fall into the water located in fountain base, unplug the fountain and turn off circuit breaker before trying to put the fountain pieces back in place.
4. If any leakage occurs around the pump housing, turn off the circuit breaker immediately and have the pump serviced by a registered technician.
5. Do not operate the fountain if the pump has been dropped or has a damaged power cord or plug.
6. If the plug or your wall receptacle gets wet due to water dripping down the power cord or for any other reason, do not remove the plug from the wall outlet until the circuit breaker is turned off.

NOTE: Allow the pump power cord to hang at a lower level than the wall outlet to form a “drip loop”. This will help prevent water from dripping down the power cord and getting into the wall outlet.

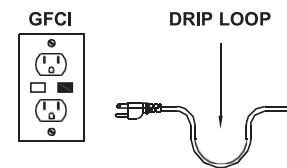

7. Always unplug the fountain pump and any other independent electrical accessories (e.g. lights) from the outlet when not in use and before cleaning or replacing parts.
8. Disconnect the power cord from the outlet by holding the plug, not by pulling on the power cord.
9. Do not expose the pump to direct sunlight or to low temperatures for any period of time.
10. Keep the power cord away from high temperatures or heat sources.
11. This fountain pump is not intended for commercial use.
12. **Do not plug in pump until it is completely submerged in water! Doing so will activate the safety shut off and the pump will not turn on!**

PACKAGE CONTENTS

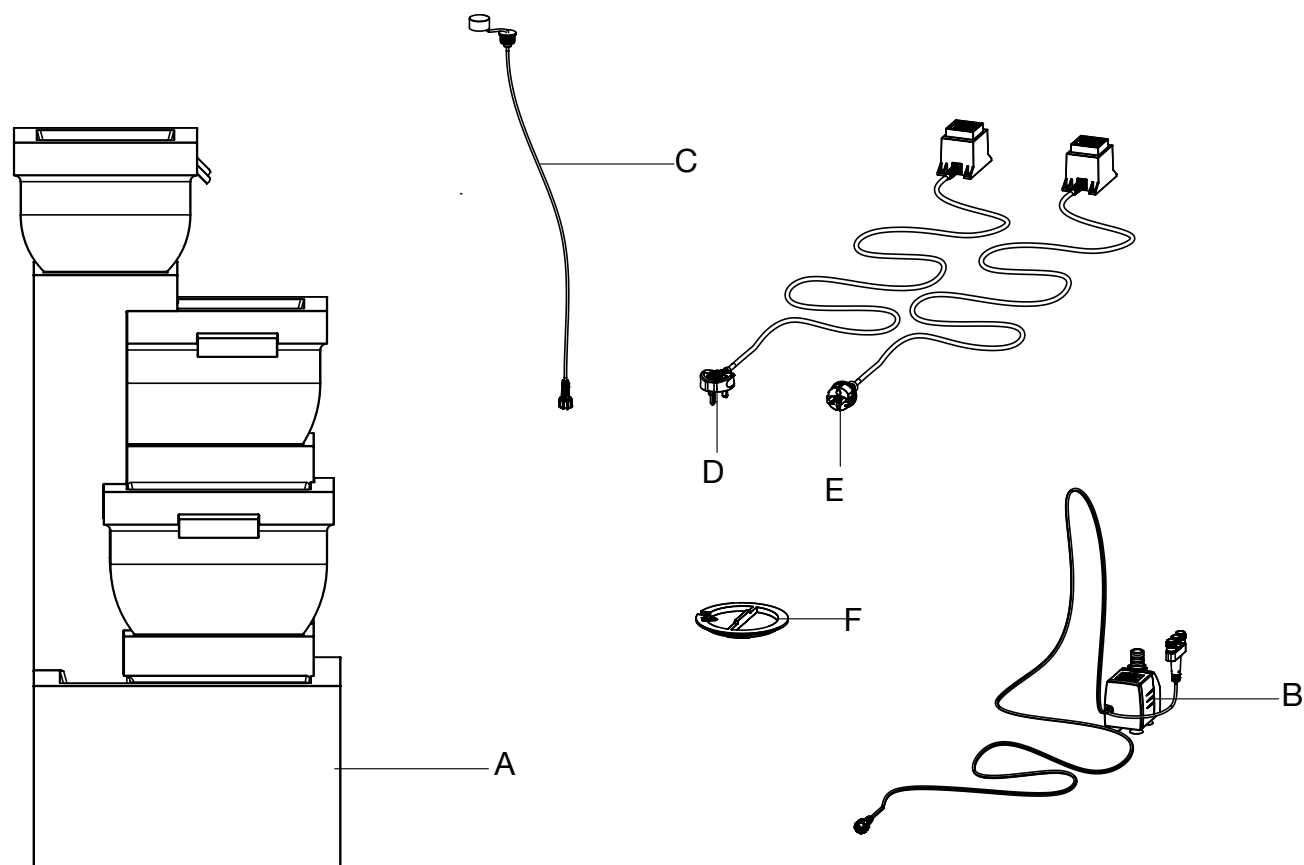

Item	Description	Qty
A	Fountain	1
B	Pump 電源	1
C	LED light (preassembled)	3
D	Transformer (BS plug)	1
E	Transformer (GS plug)	1
F	Back cap	1

PREPARATION

Before beginning assembly of product, make sure all parts are present. Compare parts with package contents list. If any part is missing or damaged, do not attempt to assemble the product.

Estimated Assembly Time: 10 minutes

No tools required.



CONTACT US

Questions, problems, missing parts?

Before returning to your retailer, reach out to our customer service department.

Toll free phone	1-877-447-4768 Monday - Friday, 9:00 am - 5:30 pm EST
Email	customerservice@ghpgroupinc.com
Website	www.ghpgroupinc.com

ASSEMBLY INSTRUCTIONS

1. Place fountain (A) on a flat level surface. Pull out the flexible hose from the inside of fountain and connect it to the outlet of the pump (B) tightly. Place the pump into the inside of the fountain. Pull out power cord of LED lights (C) from the inside of fountain (A) and plug the ends into the pump (B). Screw the pre-assembled ring over the cable to secure the connection.

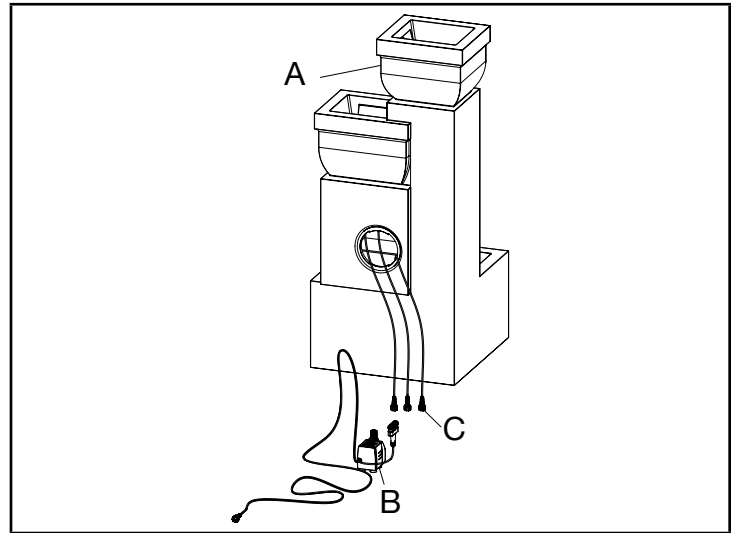

2. Choose the appropriate transformer for your location, two are available BS and GS transformer. Proceed to connect it with the pump (B).

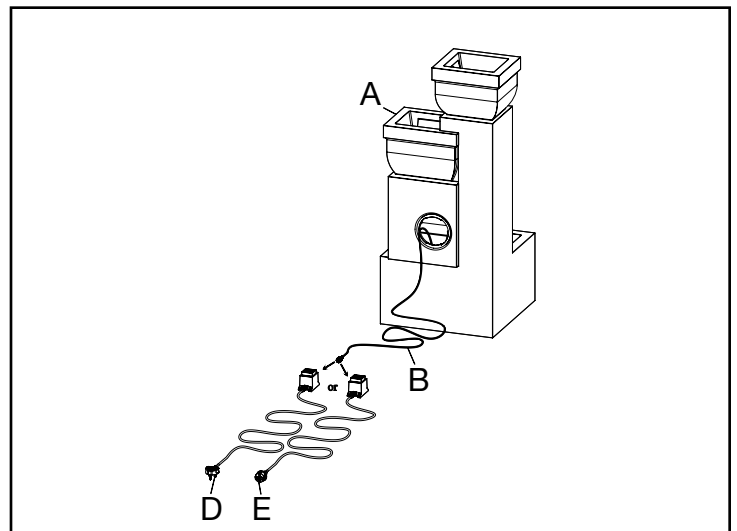

3. Attach the back cap (F) to the opening on the back of the fountain (A). Make sure to feed the pump's power cords through the small notch on the back cap (F).

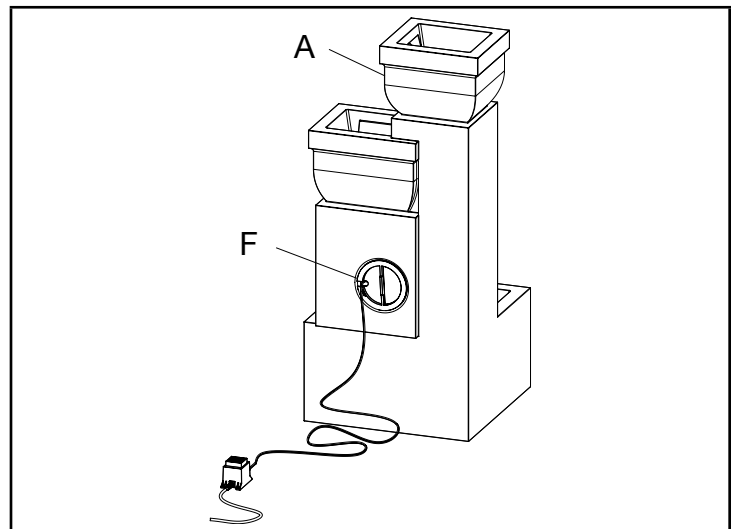

ASSEMBLY INSTRUCTIONS

4. Fill the reservoir of fountain (A) with clean water carefully. Always make sure the pump can be submerged completely. Plug the pump and the transformer into the outlet then switch it on, the water will start to flow soon.



CAUTION

Be careful not to spill water onto the plug of the pump. Although the pump is equipped with a safety shut-off device, to avoid damage it is recommended not to let it run dry.

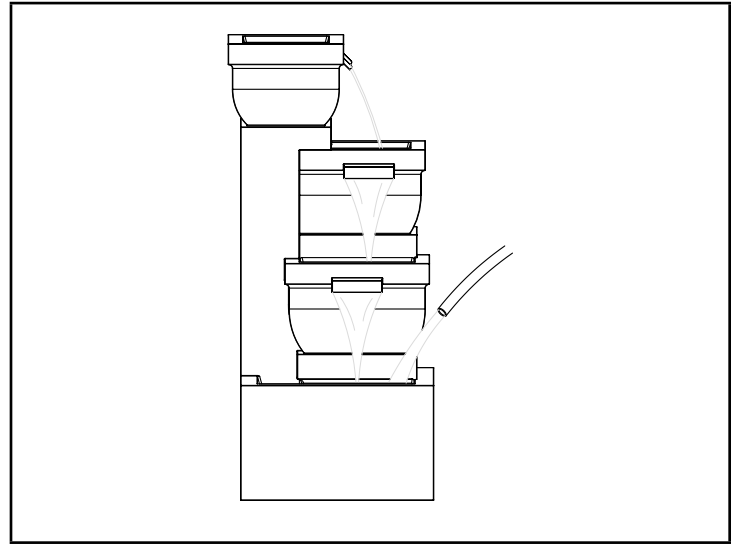

OPERATING INSTRUCTIONS

While fountain is designed to operate as splash free as possible, some water splashing out of the fountain is inevitable. Place the fountain in a location where any splashing will not cause damage. Always keep the fountain working with sufficient water and clean of debris and dirt to ensure proper functioning of the pump.

Operating Fountain

ALWAYS MAKE SURE THE PUMP IS FULLY SUBMERGED UNDER THE WATERLINE PRIOR TO TURNING PUMP ON.

1. Check that there is enough water in the reservoir.
2. Plug in pump cord into outlet and switch on, pump will start to work.
3. The water flow rate can be increased or decreased by moving the flow rate controller on the water pump to the +/- signs.
4. Turn off power outlet switch, and the pump will stop working.
5. Unplug fountain from outlet if not in use for a long period of time.

Adjust the flow rate to achieve the desired effect and to minimize any splashing. Splashing can occur if the flow rate is too high or the reservoir is too full. The flow rate can be increased or decreased by moving the flow rate control switch towards the '+/max' or '-/min' positions.

Note:

1. Drain the water if you don't plan to use the fountain for a long time to prevent mosquito breeding and water odor.
2. Be sure to drain all water during winter months or cold seasons to prevent reservoir from cracking or breaking.



WARNING:

Please check and ensure the power cord is not damaged before using this appliance.

Minimum Water Level

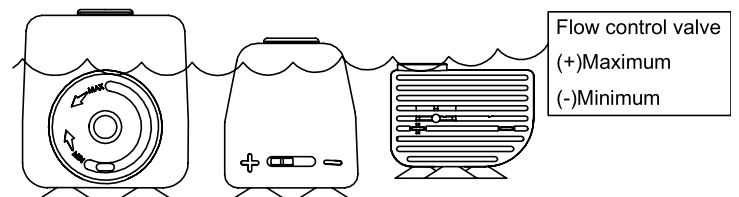

CARE AND MAINTENANCE

- If necessary, clean the fountain with a soft cloth and change the water frequently. Due to water evaporation, you may see a buildup of white residue on the fountain surface from mineral content in the water supply. To prevent such buildup, regularly clean the fountain with soap and water. Do not use any abrasive, which may damage the applied finish.
- Use of water clarifier or algacide of any kind will damage the paint on the fountain and will not be covered under the manufacturer's warranty.
- Check regularly that the water reservoir has sufficient water to cover the pump at all times. It will be necessary to check more frequently in warm or windy weather.
- Disconnect the power and empty the reservoir if the fountain will not be used for an extended time.
- If installed outdoors and in a freeze-prone area of the country, ensure all water is removed and the unit is completely dry before temperatures drop too low. This product is NOT to be operated below 5°C/41°F or freeze damage may occur.
- **Store your product indoors during the winter months. Avoiding extreme cold temperatures will prevent exposure damage.**
- Do not operate with water temperature above 35°C/95°F.
- Keep this manual for future reference.

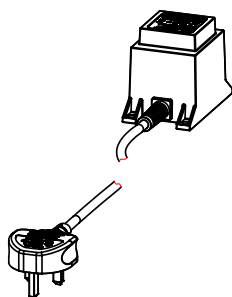

Transformer (BS PLUG)

 **AC ADAPTOR**

MODEL:KCAC-1202100

INPUT:230VAC 50Hz

OUTPUT:12VAC 2100mA

   130°C  

  Efficiency level 

YANG YUAN ELECTRONIC CO.,LTD
Two Building,KunHo A District.GangZi Zone,
Changping Town,DongGuan City,GuangDong
Province,China MADE IN CHINA 2302

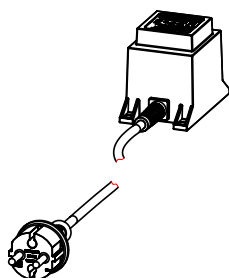

Transformer (GS PLUG)

 **AC ADAPTOR**

MODEL:KCAC-1202100

INPUT:230VAC 50Hz

OUTPUT:12VAC 2100mA

   130°C  

  Efficiency level 

YANG YUAN ELECTRONIC CO.,LTD
Two Building,KunHo A District.GangZi Zone,
Changping Town,DongGuan City,GuangDong
Province,China MADE IN CHINA 2302

CARE AND MAINTENANCE

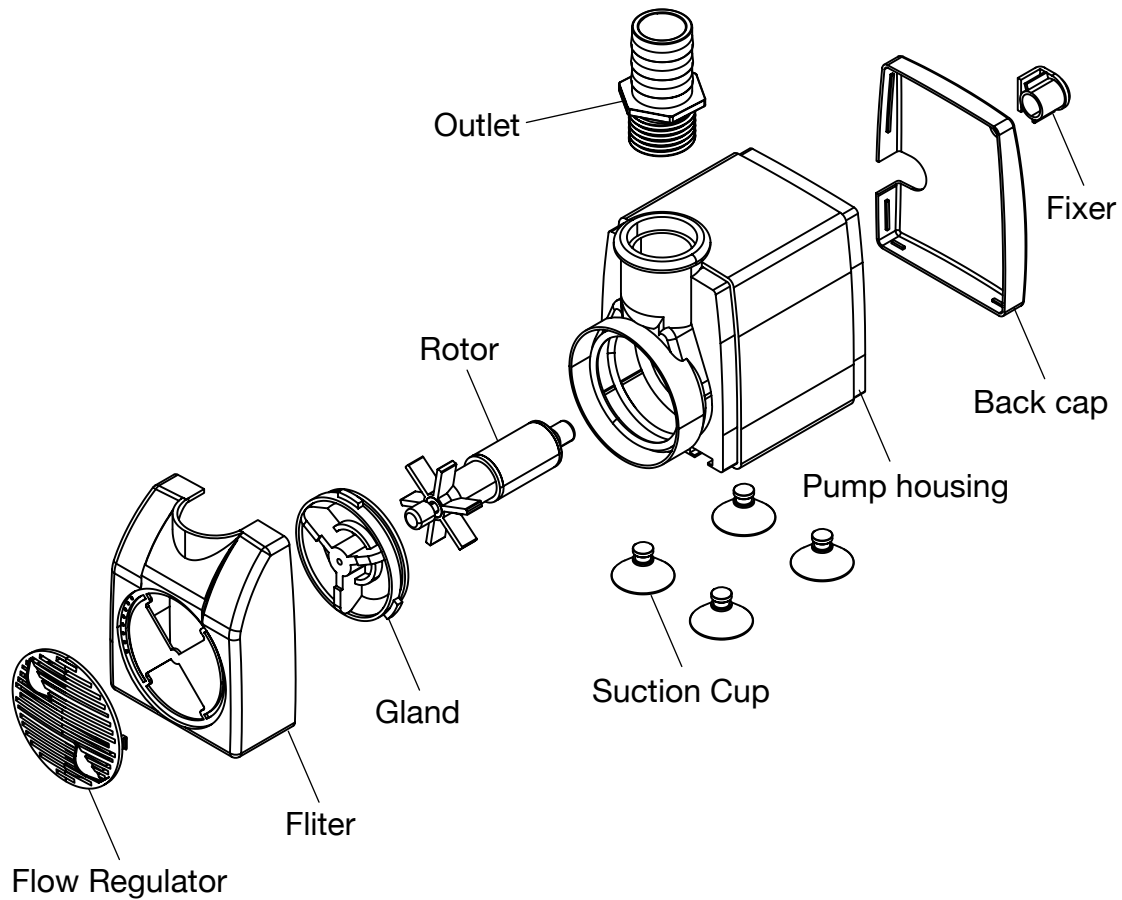

Model#	Description	Flow Height
JR-1100LV	water pump	170cm
Frequency	Volt.	Power
50 Hz	12 v	22W

NOTE: The pump data in this manual is from lab tests. The actual pump may be different due to the method of production or technical improvements. This data can be used as a reference when purchasing a similar pump.

TROUBLESHOOTING

Problem	Solution
If the pump does not run	Check the circuit breaker or try another outlet.
	Check the water level in the fountain. Running the pump without sufficient water can damage the pump.
	Check the setting of the flow control on the pump and adjust the flow.
	Check the pump discharge and intake for dirt and debris.
If the hose is blocked	The pump might be “air locked.” Plug and unplug the pump several times to release the air inside the pump.
	Check and reconnect the cord and try again.

WARRANTY

If within one years from the date of original purchase, this item fails due to a defect in materials or workmanship, we will replace or repair at our option, free of charge. To order parts or to obtain warranty service, call 1-877-447-4768, 9:00 a.m. - 5:30 p.m., EST, Monday - Friday. This warranty does not cover defects resulting from improper or abnormal use, misuse, accident, or alteration. Failure to follow all instructions in the owner’s manual will also void this warranty. The manufacturer will not be liable for incidental or consequential damages, or common erosion of outdoor products. Some states do not allow the exclusion or limitation of incidental or consequential damages, so the above limitation may not apply to you. This warranty gives you specific legal rights, and you may also have other rights which vary from state to state.



GHP Group, INC.
6440 W Howard St.,
Niles, IL 60714
1-877-447-4768 | ghpgroupinc.com

REPLACEMENT PARTS

For replacement parts call our customer service department at 1-877-447-4768, 9:00 a.m. - 5:30 p.m., EST, Monday - Friday, or please email customerservice@ghpgroupinc.com. All languages available through translation services.

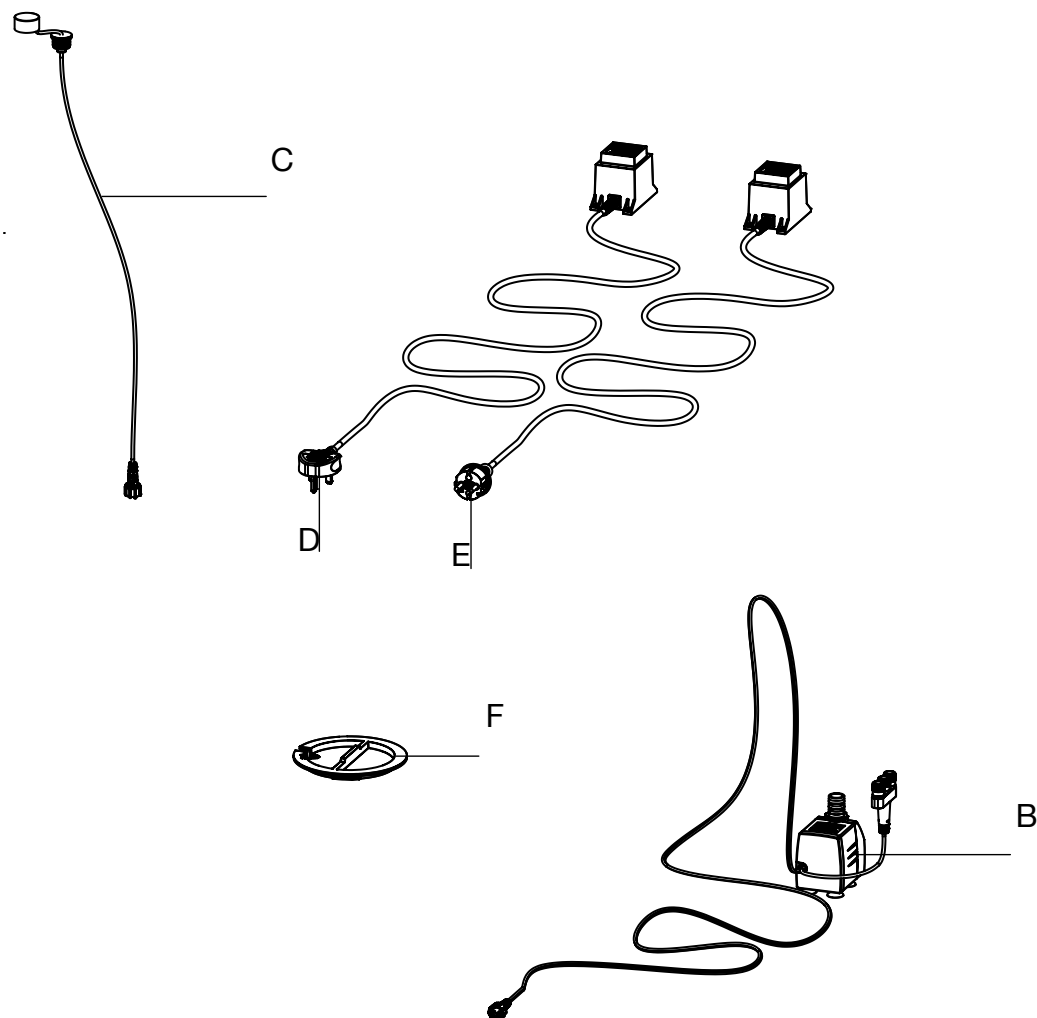

Item	Description	Part #
B	Pump ^{UK} _{USA}	50-01-304
C	LED light (preassembled)	50-01-305
D	Transformer (BS plug)	50-01-306
E	Transformer (GS plug)	50-01-307
F	Back cap	50-01-121-B

Costco Wholesale Iceland ehf.
Kauptún 3-7, 210 Gardabaer
Iceland
www.costco.is

Costco Wholesale UK Ltd /
Costco Online UK Ltd
Hartspring Lane
Watford, Herts
WD25 8JS
United Kingdom
01923 213113
www.costco.co.uk